

PROPLATE

POLISHED STAINLESS 1.4016 STEEL
SELF-ADHESIVE OR PUNCHED

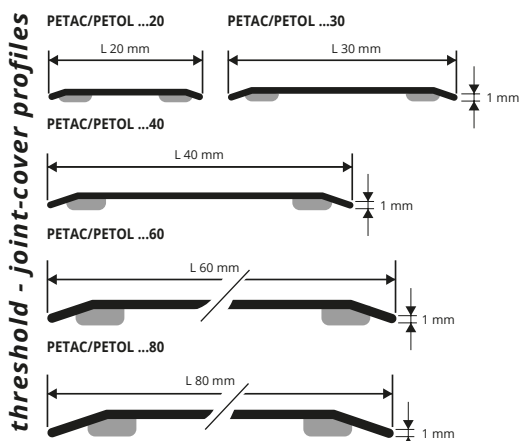

EXAMPLES AND INSTRUCTIONS FOR LAYING METHODS



1. Choose "PROPLATE" in the required width and material and whether punched or with self-adhesive backing.
2. Cut the profile to the required length. When laying the self-adhesive Proplate, clean, degrease and dry the surface, checking that the temperature for application is at least 15°.
3. Remove the protective paper from the adhesive and lay the profile correctly applying a uniform vertical pressure by hand without moving the profile and without using iron/steel hammers.
4. When laying the punched version, align the profile and mark the position of the holes using the holes in the profile as reference.
5. Insert suitable screw anchors (usually Ø 3mm screws & 5x25mm screw anchors)
6. Align the profile and tighten the galvanised or brassed flathead screws.

PROPLATE is a flat joint-cover profile with special profiled edges for perfect adherence to flooring. Made in stainless steel 1.4016 with a protective film and available with or without adhesive or for certain widths also in the punched version. Available in widths of 20 - 30 - 40 - 60 - 80 mm with protective film.

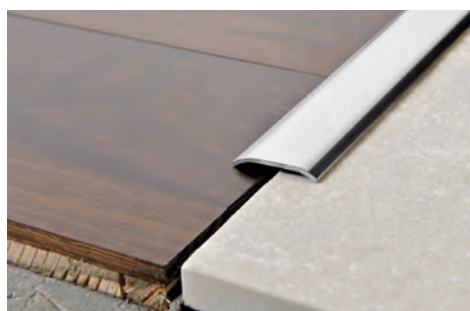

POLISHED STAINLESS 1.4016 ST. thermo packed - ADHESIVE
bar length 2,70 lm - pack. 20 Pcs - 54 lm (L 20 - 30mm - 108 lm) - 10/10 mm

Article	Width		
PETAC 20A	20mm		
PETAC 30A	30mm		
PETAC 40A	40mm		
PETAC 60A	60mm		
PETAC 80A	80mm		

POLISHED STAINLESS 1.4016 STEEL thermo packed - without holes
bar length 2,70 lm - pack. 20 Pcs - 54 lm - 10/10 mm

Article	Width		
PETAC 60	60mm		
PETAC 80	80mm		

PETAC 60A/80A/60/80, with 12/10 thickness available on demand.

PUNCHED POLISHED STAINLESS 1.4016 ST. with protective film
bar length 2,70 lm - pack. 20 Pcs - 54 lm (L 30mm - 108 lm) - 10/10 mm

Article	Width		
PETAC 30F	30mm		
PETAC 40F	40mm		



POLISHED STAINLESS 1.4016 ST. thermo packed
ADHESIVE bar length 0,93 lm - pack. 20 Pcs - 10/10 mm

Article	Width		
PETAC 309AS	30mm		
PETAC 609AS	60mm		
PETAC 809AS	80mm		

POLISHED STAINLESS 1.4016 ST. thermo packed -
PUNCHED WITH SCREWS bar length 0,93 lm - pack. 20 Pcs - 10/10 mm

Article	Width		
PETAC 309FS	30mm		

COLOURS



PROPLATE

POLISHED BRASS
SELF-ADHESIVE OR PUNCHED

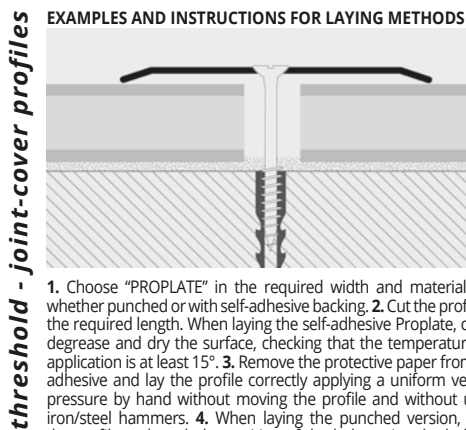

EXAMPLES AND INSTRUCTIONS FOR LAYING METHODS

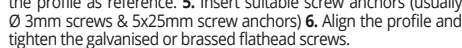

1. Choose "PROPLATE" in the required width and material and whether punched or with self-adhesive backing.
2. Cut the profile to the required length. When laying the self-adhesive Proplate, clean, degrease and dry the surface, checking that the temperature for application is at least 15°.
3. Remove the protective paper from the adhesive and lay the profile correctly applying a uniform vertical pressure by hand without moving the profile and without using iron/steel hammers.
4. When laying the punched version, align the profile and mark the position of the holes using the holes in the profile as reference.
5. Insert suitable screw anchors (usually Ø 3mm screws & 5x25mm screw anchors)
6. Align the profile and tighten the galvanised or brassed flathead screws.

COLOURS



PROPLATE is a flat joint-cover profile with special profiled edges for perfect adherence to flooring. Made in polished brass with a protective film and available with or without adhesive or for certain widths also in the punched version. Available in widths of 20 - 30 - 40 - 60 - 80 mm with protective film.



POLISHED BRASS thermo packed ADHESIVE
bar length 2,70 lm - pack. 20 Pcs - 54 lm (L 20/30mm - 108 lm) - 10/10 mm

Article	Width		
PETOL 20A	20mm		
PETOL 30A	30mm		
PETOL 40A	40mm		
PETOL 60A	60mm		
PETOL 80A	80mm		

POLISHED BRASS thermo packed WITHOUT HOLES
bar length 2,70 lm - pack. 20 Pcs - 54 lm (L 20 mm - 108 lm) - 10/10 mm

Article	Width		
PETOL 20	20mm		
PETOL 60	60mm		
PETOL 80	80mm		

PETOL 60A/80A/60/80 with 13/10 thickness available on demand.

POLISHED BRASS with protective film PUNCHED
bar length 2,70 lm - pack. 20 Pcs - 54 lm (L 30 mm - 108 lm) - 10/10 mm

Article	Width		
PETOL 30F	30mm		
PETOL 40F	40mm		

POLISHED BRASS thermo packed ADHESIVE
bar length 0,83 lm - pack. 20 Pcs - 10/10 mm

Article	Width		
PETOL 308AS	30mm		*
PETOL 408AS	40mm		*

POLISHED BRASS thermo packed
bar length 0,93 lm - pack. 20 Pcs - 10/10 mm

Article	Width		
PETOL 309AS	30mm		
PETOL 309FS	30mm		
PETOL 409AS	40mm		
PETOL 409FS	40mm		*
PETOL 609AS	60mm		*
PETOL 809AS	80mm		*

*"AS" at the end of the product code = Item with adhesive
*"FS" at the end of the product code = Punched Item

POLISHED BRASS thermo packed
bar length 1,03 lm - pack. 20 Pcs - 10/10 mm

Article	Width		
PETOL 3010AS	30mm		
PETOL 4010AS	40mm		
PETOL 4010FS	40mm		*

*"AS" at the end of the product code = Item with adhesive
*"FS" at the end of the product code = Punched Item

POLISHED BRASS thermo packed ADHESIVE
bar length 1,66 lm - pack. 20 Pcs - 10/10 mm

Article	Width		
PETOL 3016AS	30mm		*
PETOL 4016AS	40mm		*

* = Production on demand with minimum quantity of 100 pcs. Production delay 4/5 weeks. Price to be agreed