

**PROSHELL D ALL** is a profile in anodized and polished aluminum with a visible 45° sloping surface. The profile allows to connect the floor and wall coverings in ceramic and mosaic with low thickness. It is particularly suitable to ensure cleanliness and hygiene in every kind of environment where good resistance to mechanical and chemical stresses are required. Its particular section and availability in three different finishes, make **PROSHELL D ALL** a much sought after profile.

## PROSHELL D ALL

ANODIZED SILVER, POLISHED CHROME AND GOLD ALUMINIUM

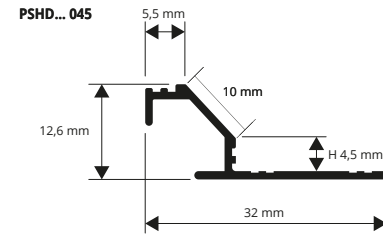

**ANODIZED SILVER ALUMINIUM thermo packed**  
bar length 2,7 lm - pack. 40 Pcs - 108 lm

Article	H mm
PSHDAA 045	4,5

**POLISHED CHROME/GOLD ALUMINIUM thermo packed**  
bar length 2,7 lm - pack. 40 Pcs - 108 lm

Article	H mm
PSHDBC 045	4,5
PSHDBO 045	4,5

### EXAMPLES AND INSTRUCTIONS FOR LAYING METHODS

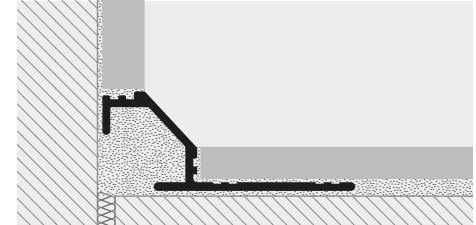

1. Choose "PROSHELL D ALL" according to the desired finish.
2. Cut "PROSHELL D ALL" to the desired length and apply the adhesive on the support where the profile will be laid.
3. Press the anchoring flange of "PROSHELL D ALL" into the adhesive.
4. Lay the tiles, aligning them with the profile leaving a 2 mm joint. Remove immediately all remains of adhesive from the surface of the profile.
5. Fill the joints between the profile and the tiles with grout, in order to avoid water stagnation. Remove immediately all the remains of grout from the surface of the profile.

### COLOURS

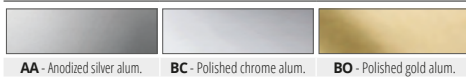

**PROSHELL R ALL** is a cove-shaped profile in anodized and polished aluminum. The profile allows to connect the floor and wall coverings in ceramic and mosaic with low thickness. It is particularly suitable to ensure cleanliness and hygiene in every kind of environment where good resistance to mechanical and chemical stresses are required. Its particular section and availability in three different finishes, make **PROSHELL R ALL** a much sought after profile.

## PROSHELL R ALL

ANODIZED SILVER, POLISHED CHROME AND GOLD ALUMINIUM



**ANODIZED SILVER ALUMINIUM thermo packed**  
bar length 2,7 lm - pack. 40 Pcs - 108 lm

Article	H mm
PSHRAA 045	4,5

**POLISHED CHROME/GOLD ALUMINIUM thermo packed**  
bar length 2,7 lm - pack. 40 Pcs - 108 lm

Article	H mm
PSHRBC 045	4,5
PSHRBO 045	4,5

### COLOURS

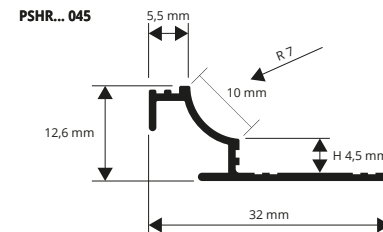
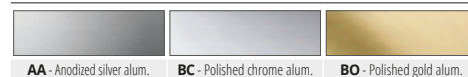

### EXAMPLES AND INSTRUCTIONS FOR LAYING METHODS

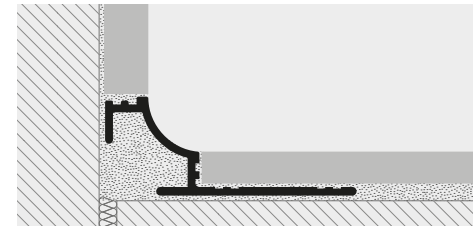

1. Choose "PROSHELL R ALL" according to the desired finish.
2. Cut "PROSHELL R ALL" to the desired length and apply the adhesive on the support where the profile will be laid.
3. Press the anchoring flange of "PROSHELL R ALL" into the adhesive.
4. Lay the tiles, aligning them with the profile leaving a 2 mm joint. Remove immediately all remains of adhesive from the surface of the profile.
5. Fill the joints between the profile and the tiles with grout, in order to avoid water stagnation. Remove immediately all the remains of grout from the surface of the profile.

\* = Production on demand with minimum quantity of 100 pcs. Production delay 4/5 weeks. Price to be agreed