

PROSKIRTING

ANODIZED SILVER ALUMINIUM

PROSKIRTING is an innovative patented "cable channel" skirting in anodized aluminium. Studied and designed to resolve various problems related to the installation of skirting and to the laying of electrical, computer and telephone cables and other service systems. **PROSKIRTING** has been designed to offer a dual function: 1- **PROSKIRTING** complete PKAA 80 is a snap-on inspectable skirting consisting of a support PKGS 66 to be screwed to the wall and the visible profile **PROSKIRTING** PKAA 80. 2- **PROSKIRTING** PKAA 80 is the visible skirting profile to be fixed directly with silicone/adhesive. It is not inspectable like **PROSKIRTING** complete; it is also available in a self-adhesive version (PKAA 80A).

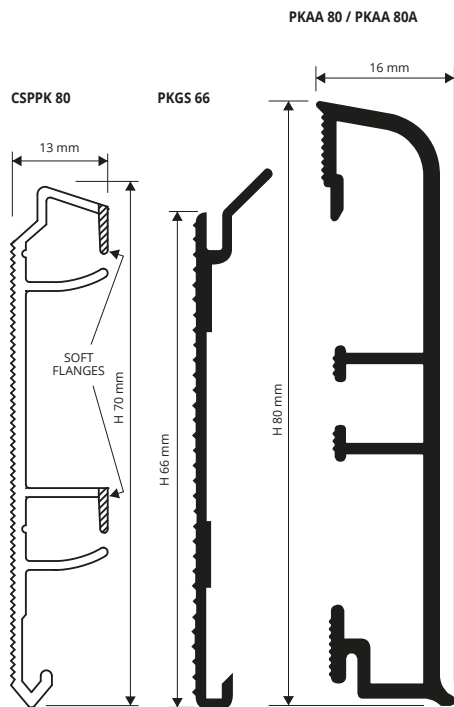

ONLY SKIRTING (for sale singly) - ANODIZED SILVER ALUMINIUM thermo packed - bar length 2 lm - pack. 10 Pcs - 20 lm

Article	H mm
PKAA 80	80
PKAA 80A	80

"A" at the end of the product code = Item with adhesive

USE PROBAND FIX FOR FIXING THE PROFILE TO THE WALL



Advantages: profile to be glued. Aesthetically superior thanks to the HI-TECH design with rounded shell-shape top and bottom edges that are easy to clean. PROSKIRTING is made in anodized aluminium with silver finish; the anodizing layer is approx. 15/20 micron. Recommended for indoor and outdoor use thanks to its good anti-oxidation properties.

- Single visible skirting profile, which may be inspectable or fixed.
- Minimum stock investment with just 2 products for three functions.
- Easy to install and clean.
- Patented innovative HI-TECH design.
- Inside-outside corners-end caps and joints varnished in the same finish as the profile.
- The PROSKIRTING profile is antistatic and stops electromagnetic and electrostatic discharge.



CABLE RACEWAY/ SUPPORT- COEXTRUDED PVC bar length 2 lm - pack. 20 Pcs - 40 lm

Article	H mm
CSPPK 80	

PUNCHED SUPPORT - NATURAL ALUMINIUM support length 2 cm - pack. 10 Pcs

Article	H mm
PKGS 66	66

ARTICLES NOT FOR SALE SINGLY



EXAMPLES AND INSTRUCTIONS FOR LAYING METHODS

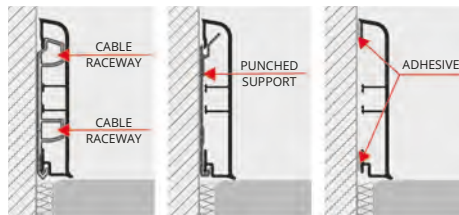

1. Choose the system with or without support 2. Fix the support to the wall with screws and screw anchors at 50 cm intervals (recommended). 3. When laying without support, thoroughly clean the surface ensuring that it is grease-free and dry, apply the silicone on the knurled sides of the profiles and lay correctly by applying pressure evenly over the whole profile without using a hammer. 4. For the "PROSKIRTING" with adhesive, application is recommended at a temperature of at least 15°. Always use the inside/outside corner linking elements and end caps for impeccable, faultless laying.

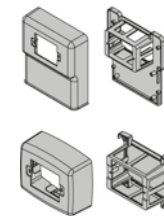

POWER SUPPLY BOX
SOCKET with FASTENING BASIS

Article	H mm
SPA 1820	

SWITCH BOX
with BOX BASIS

Article	H mm
SI 1410	

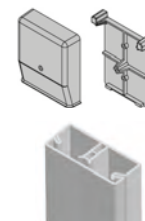

JUNCTION BOX
with FASTENING BASIS

Article	H mm
SD 1210	

VERTICAL CABLE DUCT PROFILE
bar length 2,7 lm

Article	H mm
PSPV	

It matches with CSPPK 80

COLOURS

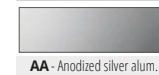

AA - Anodized silver alum.

CORNERS, END CAPS and JOINTS

VARNISHED PLASTIC SILVER FINISH.



PKAGI 80
internal corner



PKAGE 80
external corner



PKGIN 80
JOINT

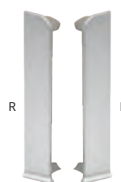

PKTDSAA 80/5
end caps

IN/EXTERNAL CORNER - VARNISHED PLASTIC (silver finish.)
pack. 5 Pcs

Article	H x L mm
PKAGI 80/5	80 x 40
PKAGE 80/5	80 x 40

JOINTS - VARNISHED PLASTIC (silver finish.) - pack. 10 Pcs

Article	H mm
PKGIN 80/10	80

END CAPS R / L - VARNISHED PLASTIC (silver finish.)

pack. 10 Pcs (5 right and 5 left)

Article	H mm
PKTDSAA 80/5	80

