



PROFLEX 5



DESCRIPTION

PROFLEX 5 is an expansion joint composed of a structure in shockproof vinyl resin and an expandable part in soft vinyl resin. The profile is equipped with punched flanges that guarantee its anchorage to the support.

MATERIAL

PROFLEX 5 is a co-extruded expansion joint composed of a structure in shockproof non-toxic vinyl resin and an expandable part in soft vinyl resin. It is available in the heights of 4.5 / 6 / 8 / 10 / 12.5 / and 15 mm with a visible surface of 10 mm. The structure in shockproof vinyl resin that protects the tile edges and the expandable part in soft vinyl resin are available in dark grey and light grey colour. The profile is equipped with punched flanges that guarantee its anchorage to the support and is resistant to fungus, bacteria and UV rays. The availability of different colours and heights, make **PROFLEX 5** a much sought-after expansion joint.

AREAS OF USE

PROFLEX 5 in co-extruded shockproof vinyl resin is suitable in indoor environments with light traffic.



WARNINGS

Do not use **PROFLEX 5** in co-extruded shockproof vinyl resin in environments subject to heavy traffic. Do not use outdoors and do not clean it with substances that contain acetone and ethyl – butyl acetate (solvents).

MAINTENANCE

PROFLEX 5 does not require any special maintenance. It is suggested to clean it with normal household cleaning products.

LAYING INSTRUCTIONS

1. Choose "**PROFLEX 5**" according to the tile thickness and desired colour.
2. Cut "**PROFLEX 5**" to the desired length and apply the adhesive on the support where the profile will be laid.
3. Place the joint exactly over the screed joint and press the anchoring flanges into the adhesive.
4. Lay the tiles, aligning them with the profile leaving 1 mm joint. After laying the joint should be 0,5 mm below the floor covering surface.
5. Fill the joints between the profile and the tiles with grout, in order to avoid water stagnation.

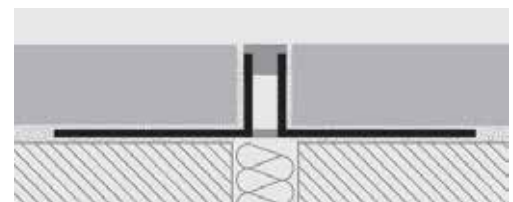
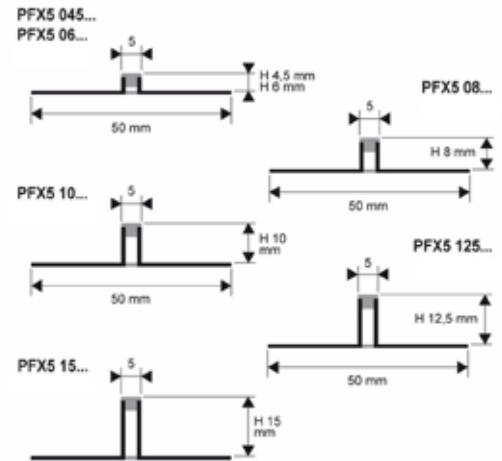

TEXT TEMPLATE FOR TENDERS

Delivery and installation of expansion joint in co-extruded vinyl resin with a height of 4.5 / 6 / 8 / 10 / 12,5 / 15 mm. It is composed of a structure in shockproof vinyl resin that protects the tile edges, and an expandable part in soft vinyl resin in dark grey / light grey colour. The visible surface is 10 mm. The profile, equipped with punched flanges that guarantee its anchorage to the support, is resistant to fungus, bacteria and UV rays, like PROFLEX 5 of the Progress Profiles company.

PFX5 045 / 06 / 08 / 10 / 125 / 15... :
Co-extruded, non-toxic shockproof vinyl resin

Profile height : _____ mm
 Profile length : _____ mt
 Material : _____ €/mt
 Application : _____ €/mt
 Total value : _____ €/mt