

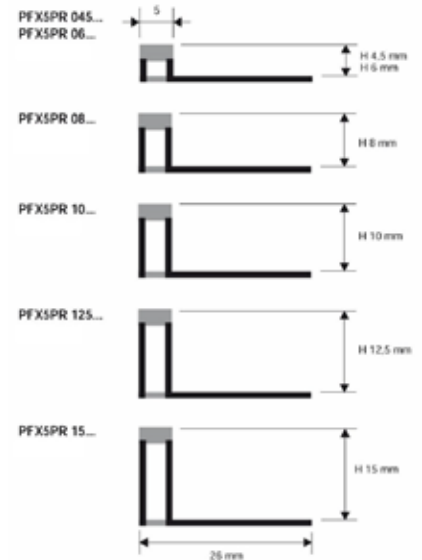

PROFLEX 5 PR



DESCRIPTION

PROFLEX 5 PR is a perimetral expansion joint composed of a structure in shockproof vinyl resin and an expandable part in soft vinyl resin. The profile is equipped with one punched flange that guarantee its anchorage to the support.

MATERIAL

PROFLEX 5 PR is a co-extruded perimetral expansion joint composed of a structure in shockproof non-toxic vinyl resin and an expandable part in soft vinyl resin. It is available in the heights of 4.5 / 8 / 10 / 12.5 and 15 mm with a visible surface of 5 mm. The structure in shockproof vinyl resin that protects the tile edges, and the expandable part in soft vinyl resin are available in dark grey and light grey colour. It is equipped with one punched flange that guarantees its anchorage to the support. The profile is resistant to fungus, bacteria and UV rays. The availability of different colours and heights, make **PROFLEX 5 PR** a much sought-after perimetral expansion joint.

AREAS OF USE

PROFLEX 5 PR in co-extruded shockproof vinyl resin is suitable in indoor environments with light traffic.

WARNINGS

Do not use **PROFLEX 5 PR** in co-extruded shockproof vinyl resin in environments subject to heavy traffic. Do not use outdoor and do not clean it with substances that contain acetone and ethyl – butyl acetate (solvents).

MAINTENANCE

PROFLEX 5 PR does not require any special maintenance. It is suggested to clean it with normal household cleaning products.

LAYING INSTRUCTIONS

1. Choose "**PROFLEX 5 PR**" according to the tile thickness and desired colour.
2. Cut "**PROFLEX 5 PR**" to the desired length and apply the adhesive on the support where the profile will be laid.
3. Place "**PROFLEX 5 PR**" along the perimeters and press the anchoring flange into the adhesive.
4. Lay the tiles, aligning them with the profile leaving 1 mm joint. After laying the joint should be 0.5 mm below the floor covering surface.
5. Fill the joints between the profile and the tiles with grout, in order to avoid water stagnation.

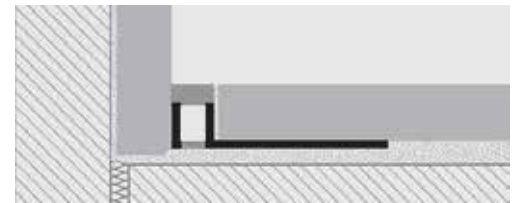

TEXT TEMPLATE FOR TENDERS

Delivery and installation of perimetral expansion joint in co-extruded vinyl resin with a height of 4.5 / 8 / 10 / 12.5 / 15 mm. It is composed of a structure in shockproof vinyl resin that protects the tile edges and an expandable part in soft vinyl resin in dark grey / light grey colour. The visible surface is 5 mm. The profile, equipped with one punched flange that guarantee its anchorage to the support, is resistant to fungus, bacteria and UV rays, like **PROFLEX 5 PR** of the Progress Profiles company.

PFX5PR 045 / 06 / 08 / 10 / 125 / 15... :
 Co-extruded, non-toxic vinyl resin

Profile height : _____ mm
 Profile length : _____ mt
 Material : _____ €/mt
 Application : _____ €/mt
 Total value : _____ €/mt