

**STYLE STAIR L** comprises a large range of aluminium stair nosing protecting profiles for step in timber, parquet, laminate or melamine material with thickness varying from 7 to 20 mm. wooden finishes are available, plus anodized finishes. The profiles is made with 3 pcs. A natural aluminium base to scew or glue to the pavement, a PIN in non-toxic rigid to insert in the TOP, then a TOP should be selected most suitable for the floor.

# STYLE STAIR L

TOP IN WOODEN FINISHES  
AND ANODIZED FINISHES  
+ PIN INSERT + ALUMINIUM BASE



**ALUM. TOP + PIN INSERT + ALUM. BASE 40 PUNCHED/PERFORATED**  
(6 anod. alum. finishes of which 3 on demand) thermo packed  
bar length 2,7 lm - pack. 20 Pcs - 54 lm (H 14 - H 16 - H 18 mm - 40,5 lm)

| Article                      | H mm    |
|------------------------------|---------|
| PINYLC... 07 (PIN insert 07) | 7 / 9   |
| PINYLC... 09 (PIN insert 09) | 10 / 12 |
| PINYLC... 11 (PIN insert 11) | 13 / 14 |
| PINYLC... 13 (PIN insert 13) | 14 / 15 |
| PINYLC... 15 (PIN insert 15) | 16 / 17 |
| PINYLC... 17 (PIN insert 17) | 18 / 20 |

COMPLETE

**ALUM. TOP COVERED + PIN INSERT + ALUM. BASE 40 PUNCHED/PERFORATED**  
(80 wooden finishes of which 57 on demand) thermo packed  
bar length 2,7 lm - pack. 20 Pcs - 54 lm (H 14 - H 16 - H 18 mm - 40,5 lm)

| Article                      | H mm    |
|------------------------------|---------|
| PINYLC... 07 (PIN insert 07) | 7 / 9   |
| PINYLC... 09 (PIN insert 09) | 10 / 12 |
| PINYLC... 11 (PIN insert 11) | 13 / 14 |
| PINYLC... 13 (PIN insert 13) | 14 / 15 |
| PINYLC... 15 (PIN insert 15) | 16 / 17 |
| PINYLC... 17 (PIN insert 17) | 18 / 20 |

COMPLETE

Available in the finishes: AO - AA - AB (AT, CH and SB available on demand with a minimum quantity order of 200 pcs) and in the wooden finishes: 04W - 05W - 13W - 18W - 21W - 25W - 29W - 30W - 31W - 32W - 33W - 34W - 35W - 36W - 37W - 38W - 39W - 41W - 42W - 44W - 45W - 58W - 54W - 55W.

The code of the selected colour must be added to the article code. E.g.: PINYLC... 07 (chosen finish anod. gold) PINYLCAO 07.

### EXAMPLES AND INSTRUCTIONS FOR LAYING METHODS

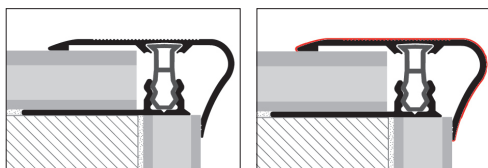

TOP IN ANODIZED FINISHES

TOP IN WOODEN FINISHES

1. Fix the base exactly over the stair riser. 2. Align the laminate/melamine/wood floor, ensuring that approx. 3/10mm gap is left on one side to accommodate the natural expansion between the floor and the base. 3. Choose the desired profile, if necessary cut TOP, PIN and BASE at the needed length and then insert the PIN in the TOP in the specific "dovetail" seat. The position the profile above the U-shaped snap-in seat of the base. 4. With the aid of a board, hammer the TOP to the desired fitting level.

### ANODIZED COLOURS



### \* ANODIZED COLOURS ON DEMAND



### WOODEN COLOURS



### \* WOODEN COLOURS ON DEMAND

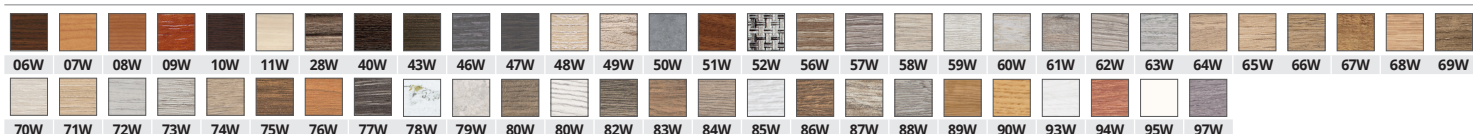

On request it is possible to realize other finishes of the color range: minimum order 200 pcs. Production delay 4/5 weeks. Price to be agreed. For sample finishes, contact the sales office for minimum quantities, timing and costs.

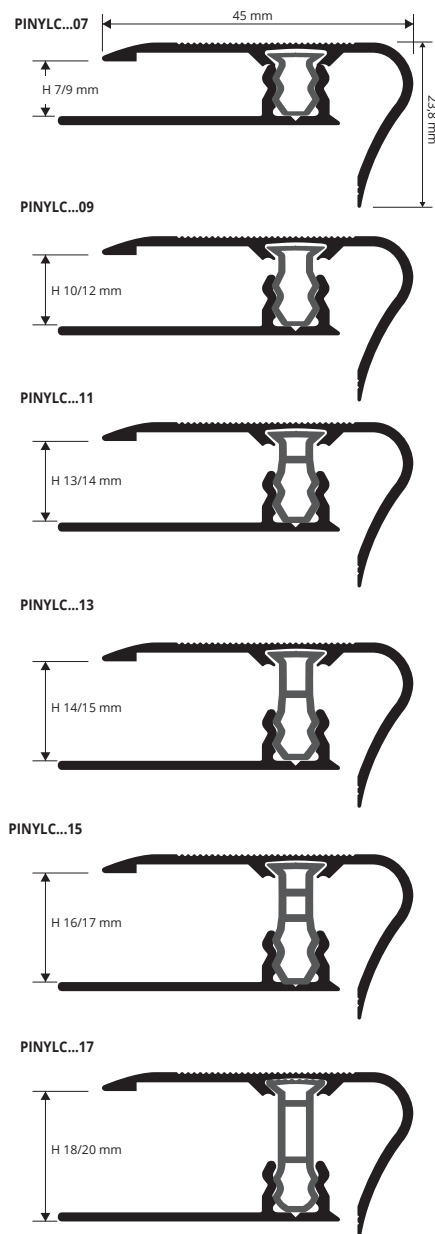

transition profiles

\* = Production on demand with minimum quantity of 200 pcs. Production delay 4/5 weeks. Price to be agreed