



PROLISTEL ACC



DESCRIPTION

PROLISTEL ACC is a stainless steel listel suitable to decorate floor and wall coverings in ceramic, mosaic and natural stone. Its particular section and the availability in four finishes and two heights, make it a much sought after profile.

MATERIAL

PROLISTEL ACC is a "C shaped" listel in polished stainless steel AISI 316L / 1.4404-V4A. It is available in the heights of 4.5 and 10 mm and with a visible surface of 10 - 15 - 20 and 25 mm. The profile is also available in the version for "internal use". Its particular section and the availability in two heights, make **PROLISTEL ACC** a much sought after profile that can be matched with **PROJOLLY**, **PROJOLLY SQUARE**, **PROJOLLY TRIANGLE** and **PROJOLLY QUART**.

AREAS OF USE

PROLISTEL ACC in stainless steel AISI 316 L / 1.4404 - V4A is suitable for every kind of environment where high resistance to mechanical and chemical stresses are required. The profile is suitable for food contact after cleaning and removing any surface residue.



WARNINGS

Don't use **PROLISTEL ACC** in stainless steel AISI 316 L / 1.4404 - V4 in environments where very strong substances are used. For cutting the profile it is recommend to use a hacksaw with steel blade and treat the cutting surface with a stainless steel passivation product.

MAINTENANCE

PROLISTEL ACC does not require any special maintenance. It is suggested to clean it with normal household cleaning products.

LAYING INSTRUCTIONS

1. Choose "**PROLISTEL ACC**" according to the tile thickness and visible surface.
2. Cut "**PROLISTEL ACC**" to the desired length and apply the adhesive on the surface where the profile will be laid.
3. Press "**PROLISTEL ACC**" into the adhesive, aligning it with the tiles leaving a 2 mm joint. Remove immediately all remains of adhesive from the surface of the profile.
4. Fill the joint between the profile and tiles with grout in order to avoid water stagnation. Remove immediately all the remains of grout from the surface of the profile.

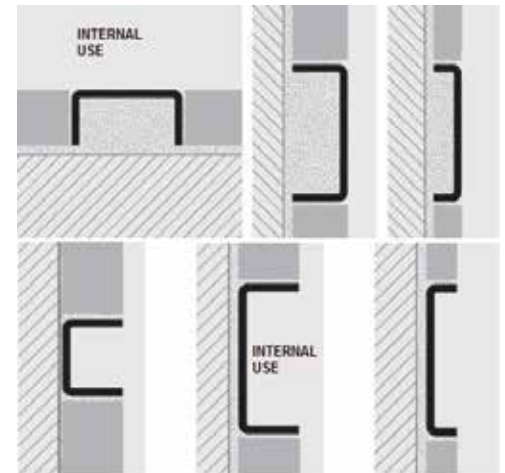
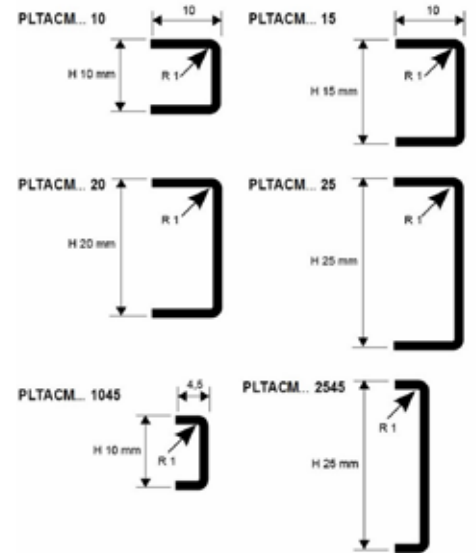

TEXT TEMPLATE FOR TENDERS

Delivery and installation of a "C" shaped listel in polished stainless steel AISI 316 L / 1.4404 - V4A. With a height of 4.5 / 10 mm and visible surface of 10 / 15 / 20 / 25 mm, like Prolistel ACC of the company Progress Profiles.

PLTACM / PLTACMI 10 / 1045 / 15 / 20 / 25 / 2545: Polished stainless steel AISI 316L/1.4404 - V4A.

Profile height : _____ mm
 Profile width : _____ mm
 Profile length: _____ mt
 Material : _____ €/mt
 Application : _____ €/mt
 Total value : _____ €/mt